

UD-1000

Function Manual



Contents

| | | |
|------------------------------|-------|-------|
| 1. UD-1000 Name of Each part | ----- | 01 |
| 2. UD-1000 usage manual | ----- | 02~03 |
| 3. Function mode List | ----- | 04~05 |
| 4. Function mode usage | ----- | 06~11 |

! Name of Each part (FAUCET)



! Name of Each part (FAUCET)

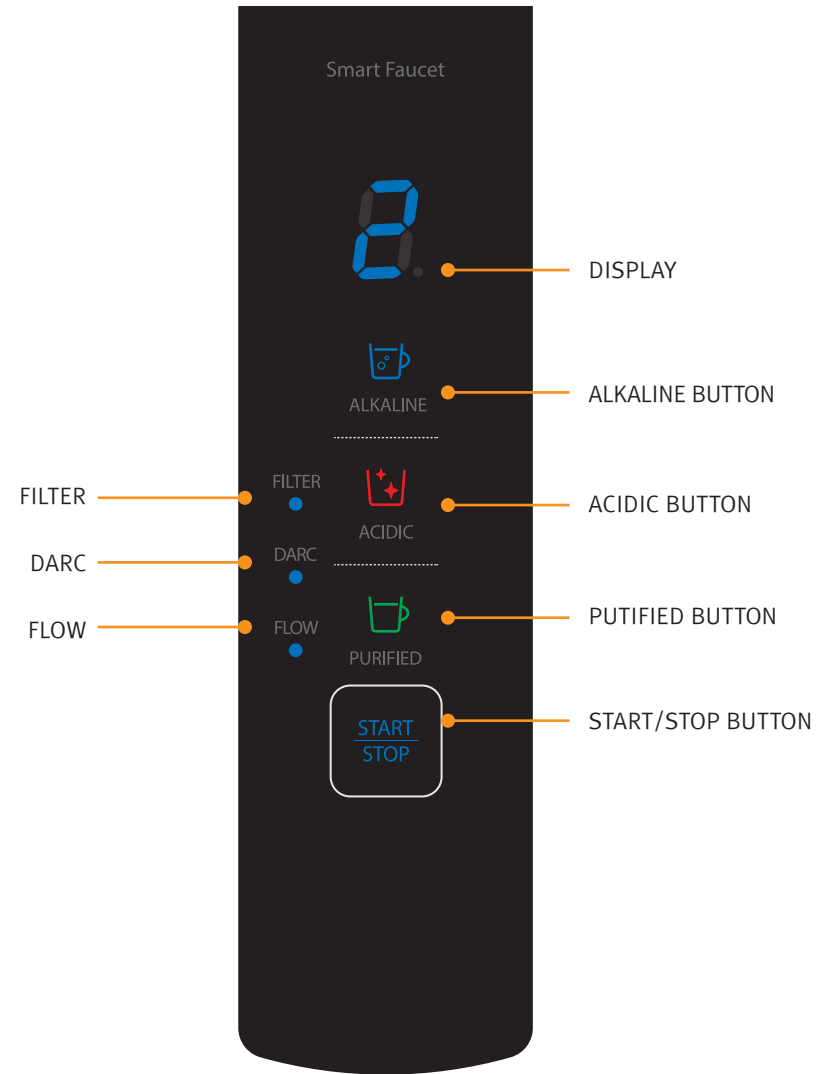

Obtaining alkali water

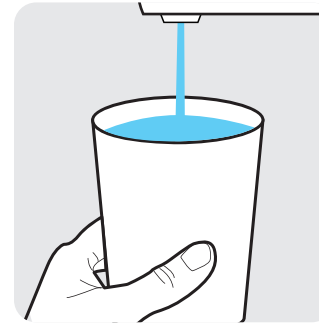
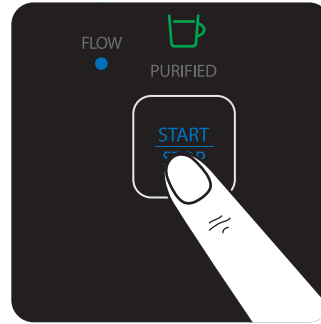
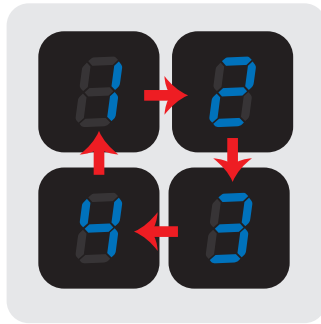
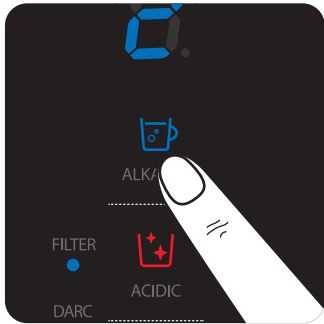

1. Touch ALKALINE button to select desired level (level 1~4)
2. After choosing the desired level of alkali water, touch the start/stop button to get water
3. Press start/stop button to stop the water after getting the desired amount of alkali water

Obtaining Acidic water

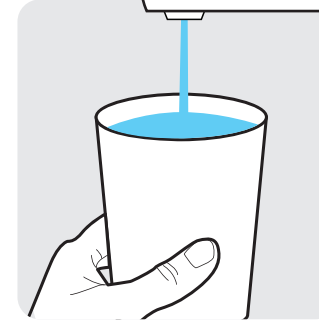
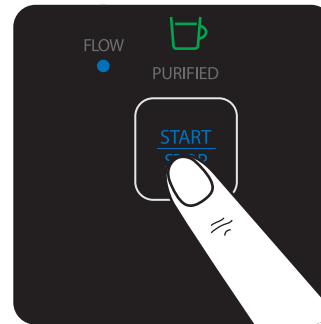
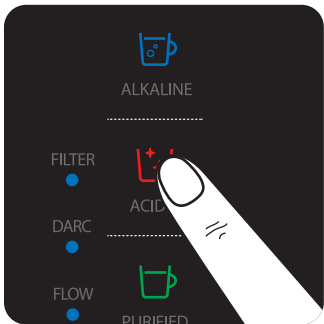

1. Touch Acidic button to select desired level (level 1~4)
2. After choosing the desired level of Acidic water, touch the start/stop button to get water
3. Press start/stop button to stop the water after getting the desired amount of Acidic water

Obtaining Purified water

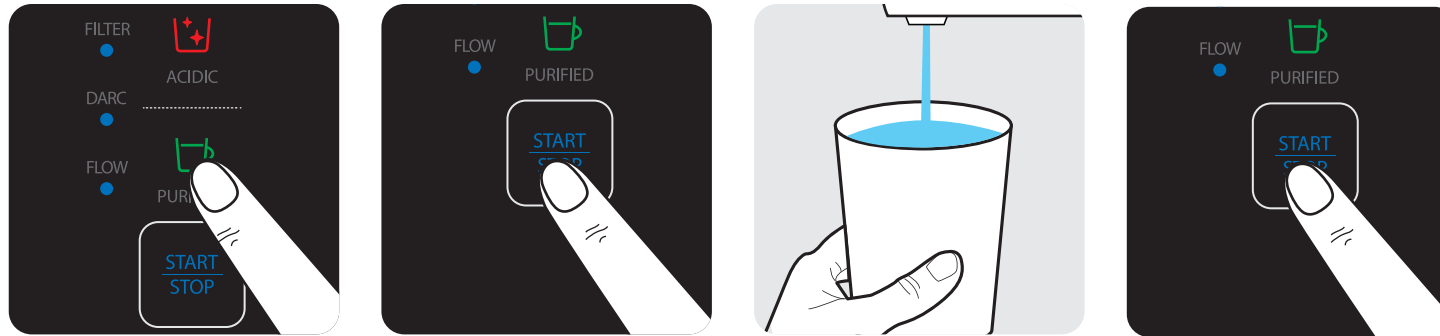

1. Touch Purified button.
2. start/stop button to get water
3. Press start/stop button to stop the water after getting the desired amount of Purified water

2-1. Function Mode List

| Division | Setting Description(Mode) | PAGE |
|----------------|---|------|
| Basic Features | ▶ Select Level : Alkaline 4(1,2,3,4), Acidic 2(1,2), Purified (0) | |
| | ▶ Buzzer Sound (Available in melody, no voice function) - General Switch Sound : Ding~ - In Stop : Ding~ - In Operation : Ding dong~ - Filter Replacement Alarm : Ding dong ding dong~ | |
| | ▶ Cleaning function(draft) < Operating Conditions > - Automatic conversion to alkaline water Level 2 when stops after using acidic water - Notification to not release water with 5 seconds alarm when using alkaline water or purified water after using acidic water (Available to intake water normally after 5 seconds) | |
| | ▶ DARC LED(BLUE) - Light on : Lights when DARC conversion system operates - Flicker : When DARC error occurs (01~07) - Lights Out : When DARC motor normally in stop, when in stop. | 06 |
| | ▶ FOLW LED(BLUE) - Light on : Normal flux (0.5 liter/minute or more) - Flicker : Normal flux (0.5 liter/minute or less) | 06 |
| | ▶ FILTER LED(BLUE) - Flicker : Filter none. - Light on : Filter Using amount remains - Lights Out : STOP condition(Irrelevant to filter remaining quantity) | 07 |
| | ▶ Filter Reset : PURIFIED KEY 5seconds Touch | 07 |

2-2. Function Mode List

| Division | MANU | Detail explanation | PAGE |
|--|--|--|---------|
| Function Mode 1 (Seltion change mode) | Initial Screen "LE 00" (LEVEL Set) | <ul style="list-style-type: none"> ▶ How to enter <ul style="list-style-type: none"> - While stopped "ALKALINE+ACIDIC" Entry by touching the switch at the same time for 3 seconds ▶ How to Disable <ul style="list-style-type: none"> - Initial Screen "ON/OFF" touching the switch ▶ Switch Purpose <ul style="list-style-type: none"> - Mode Change : PURIFIED KEY (LE ↔ FL) - Up key : ALKALINE KEY - Down Key : ACIDIC KEY | 08 - 09 |
| | LE (1~7) | <ul style="list-style-type: none"> ▶ LEVEL change(1~7) <ul style="list-style-type: none"> - Setting range : (Undefined) - MAIN PGM Depending sense | 10 |
| | FL (1~7) | <ul style="list-style-type: none"> ▶ Passive filter value change(1~7) <ul style="list-style-type: none"> - Setting range : 7(Full) - 1 : Filter none(Empty) ~ 7 : Filter full | 11 |

2-3. Function mode usage

▣ URO LED(BLUE)



Light on

When DARC conversion system operates

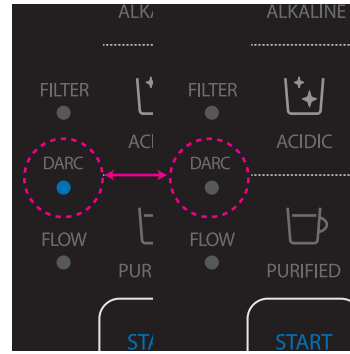

Flicker

When DARC error occurs

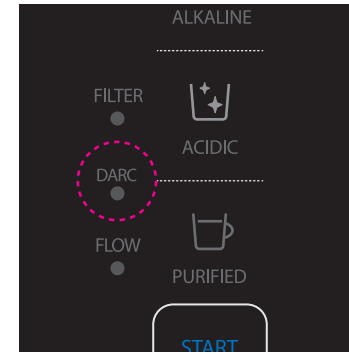

Light out

When DARC motor normally in stop

▣ FLOW LED(BLUE)

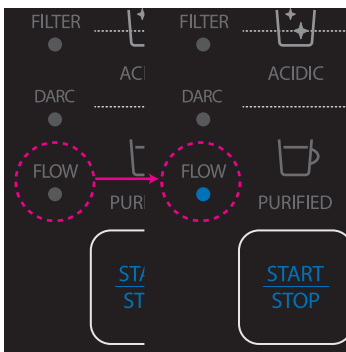

Light on

Normal flux (0.5 liter/minute or more)

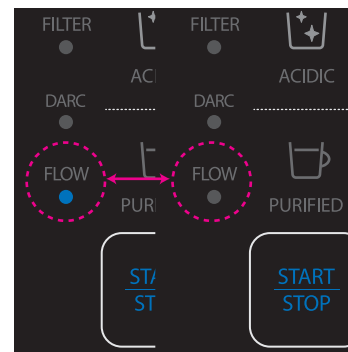

Flicker

Normal flux (0.5 liter/minute or less)

2-4. Function mode usage

▣ FILTER LED(BLUE)

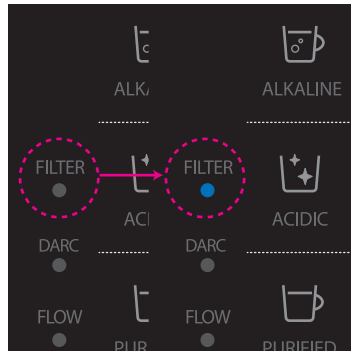

Light on
Filter Using amount remains

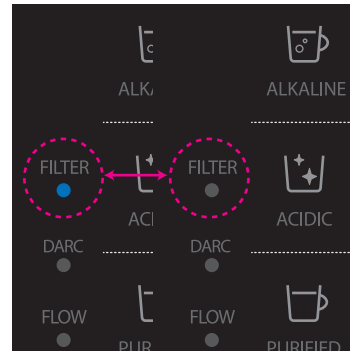

Flicker
Filter none

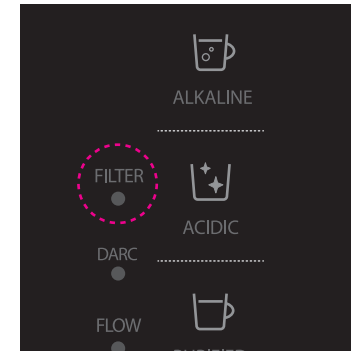

Light out - In stop
(irrelevant to filter remaining quantity)

▣ Resetting the filter

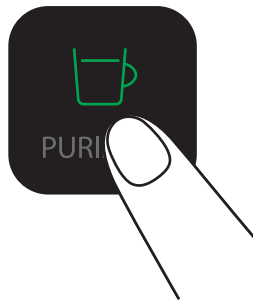

1. Hold the PURIFIED button for 5 seconds to reset the filter
2. sound "ding" with filter reset is complete

2-5. Function mode usage



[Waiting mode]

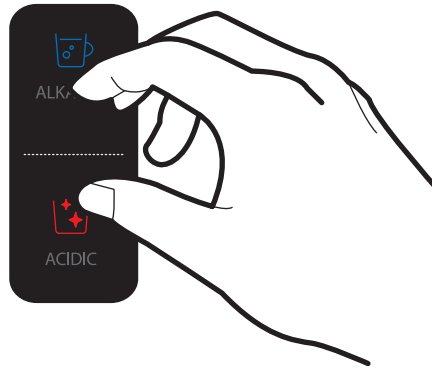

[Touch 3 seconds at once]



Function mode
Initial Screen



※ Show in LE setup value.
※ Basic LE4 setting

How to enter Function Mode

Touch "Alkaline Water+Acidic Water" switches at once for 3 seconds in stop and enter Administrator Mode.



[Function mode]

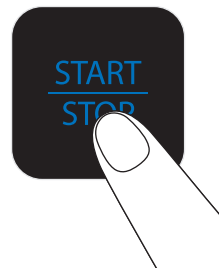
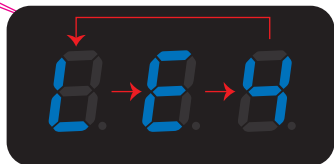

[ON/OFF Button touch]

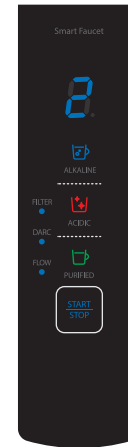

Administrator Mode
Release Complete

How to release Function Mode

When touching "ON/OFF" switch while entering Administrator Mode, Administrator Mode releases.

2-6. Function mode usage

▣ MODE Change : PURIFIED KEY (LE ↔ FL)

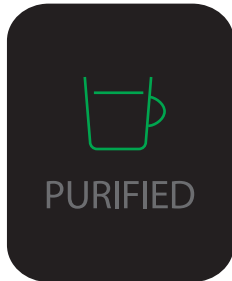

[PURIFIED BUTTON]



[LE MODE L↔E↔1 Repetitive Lighting]

※ At this time, numbers are displayed in setup value.



[FL MODE F↔L↔1 Repetitive Lighting]

※ At this time, numbers are displayed in setup value.

▣ Increase Menu Value : ALKALINE KEY



[ALKALINE UP BUTTON]



▣ Decrease Menu Value : Acidic KEY



[ACIDIC DOWN BUTTON]



2-7. Function mode usage

▣ LEVEL Change (1~7)

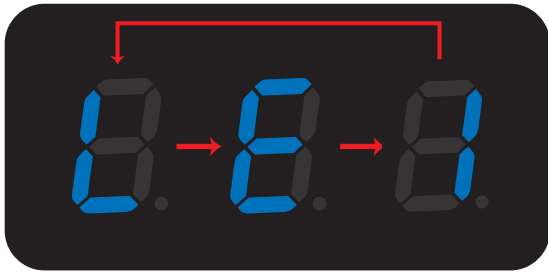

[LE1 mode]

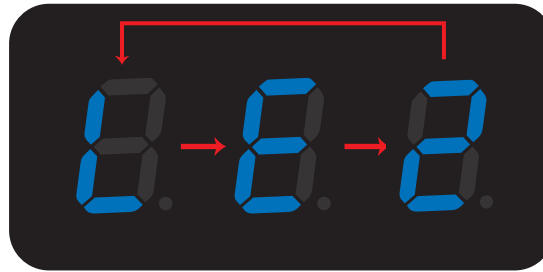

[LE2 mode]

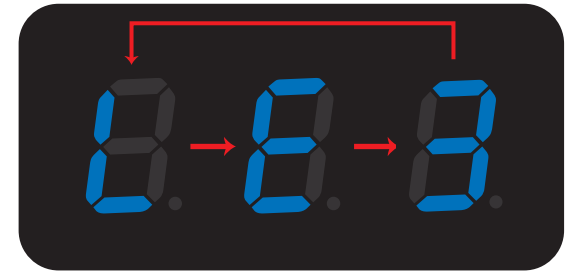

[LE3 mode]

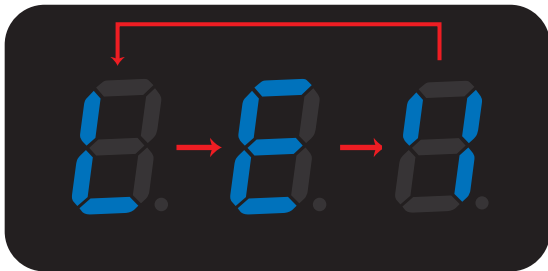

[LE4 mode]

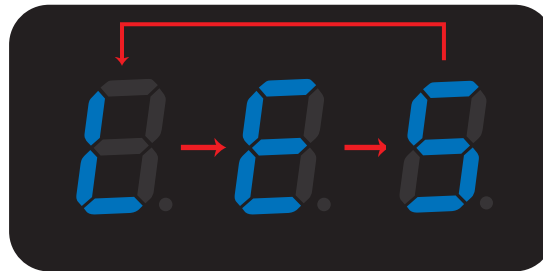

[LE5 mode]

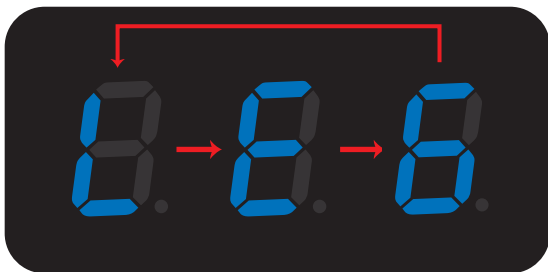

[LE6 mode]

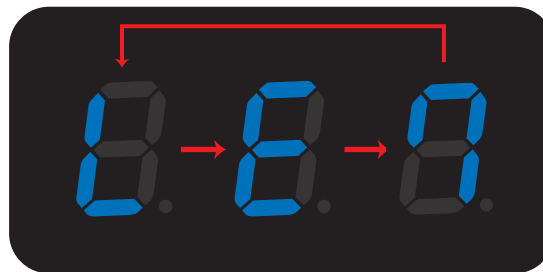

[LE7 mode]



2-8. Function mode usage

Passive filter value change(1~7)

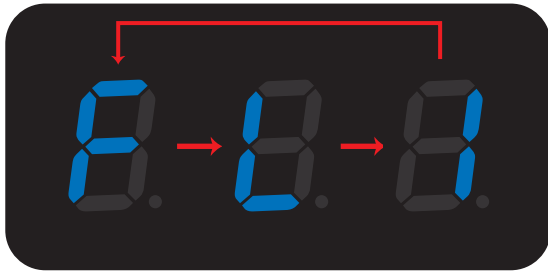

[FL1 - Remaining 0 ℓ]



[FL2 - Remaining 180 ℓ]

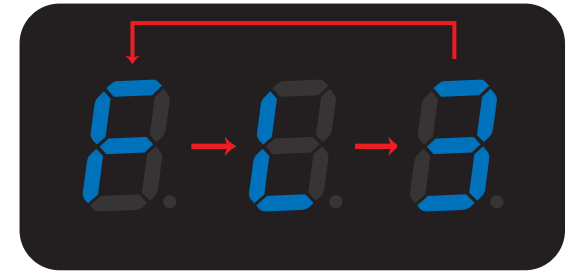

[FL3 - Remaining 864 ℓ]



[FL4 - Remaining 1,548 ℓ]



[FL5 - Remaining 2,232 ℓ]

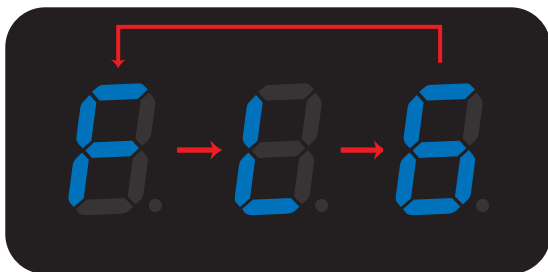

[FL6 - Remaining 2,916 ℓ]



[FL7 - Remaining 3,600 ℓ (Full)]



- Initial setting value : 7(Full)
- 1 : Filter none~
- 7 : Filter Full